



www.Zricks.com



www.Zricks.com



www.Zricks.com

8th Floor Plan



Ground Floor Plan

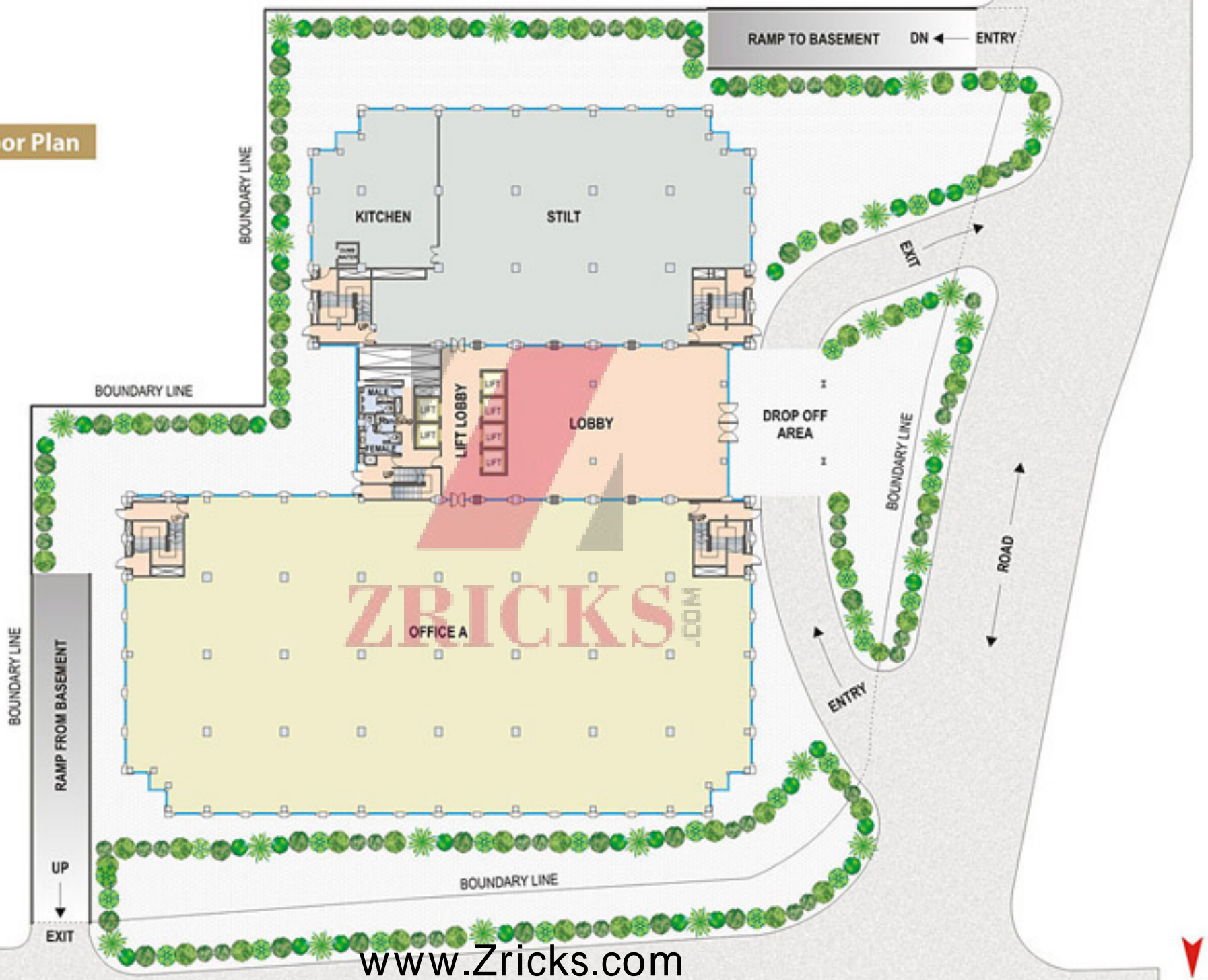



Shivaji

Siddhivinayak
Temple

Worli Seaface Road

PRABHADEVI

Veer Savarkar Road

Appasaheb Marathe Marg

New Prabhadevi
Road

Passport
Office

Century
Bazar

Site

BeauMonde

D. P. Road

Anant Dessai Road

WORLI

www.Zricks.com

Amenities

- • Energy efficient features in AC
- • Building Managements System (BMS)
- • Electrical System – IT specific features
- • Ventilation System for toilets and stairs
- • Basement Ventilation systems – Jet Fans
- • Waste water disposal system
- • Access control security system
- • Applied for LEED certification
- • Cleaning development mechanism for façade – BMU
- • 100% Power backup preventing workflow interruption and helping in maintaining maximum productivity
- • External façade in permanent materials like high performance glass, granite and aluminum panel, etc
- • Energy conservation
- • Fresh air circulation through high efficiency air filters inside the building that helps in maintaining indoor air quality and comfort for the end users
- • Motion detecting switches that will automatically shut down lighting in the unoccupied areas

Safety measures

- • Duress alarm
- • Emergency lighting in case of power failure
- • P.A. system for announcement and alarms
- • Perimeter protection
- • Anti blast film on windows
- • CCTV at perimeter and basement
- • Computerized car scanner
- • Centralized security and Access control
- • Accessible terrace area on 2nd & 8th floors
- • Fire escape balconies
- • 5 staircases for safe evacuation in case of emergency
- • Refuge floor on 5th floor for fire safety
- • Use of hydro pneumatic system with UG Tank in basement